



# Askey EZ Clone

## Quick Error-Free Device Staging

EZ Clone by Askey simplifies device configuration, eliminating the need for IT support and reducing errors from manual setup. With a simple barcode scan, organizations—big or small—can quickly and securely configure anywhere from a few devices to hundreds with this license-free solution.



### Error-free multi-device staging

Reduce setup mistakes with seamless automation



### Quick & Simple Profile Creation

Customize device configurations effortlessly



### Time-Saving Automation

Eliminate manual, time-consuming processes

### Profile Creation Made Simple: Intuitive Setup, One-Click Cloning, Centralized Management

- Connect your device to a network
- Configure device settings and security
- Perform OS updates
- Install and launch applications
- Wipe and reset the device
- Manage mobile profiles

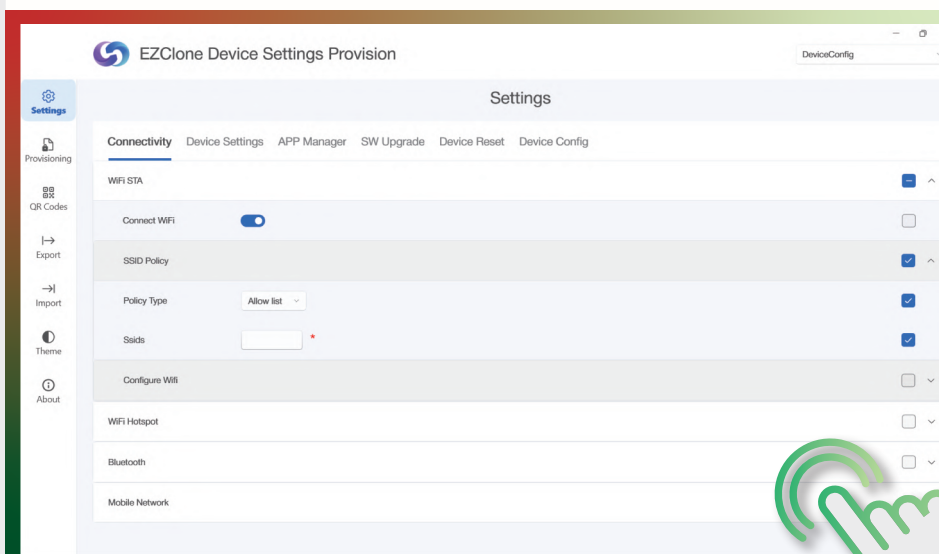

► [Download EZ Clone PC APP here](#)

## ▶ Simple Configuration

Creating a EZ Clone configuration QR code is made simple to define configurations, settings, and apps – without the need to code.

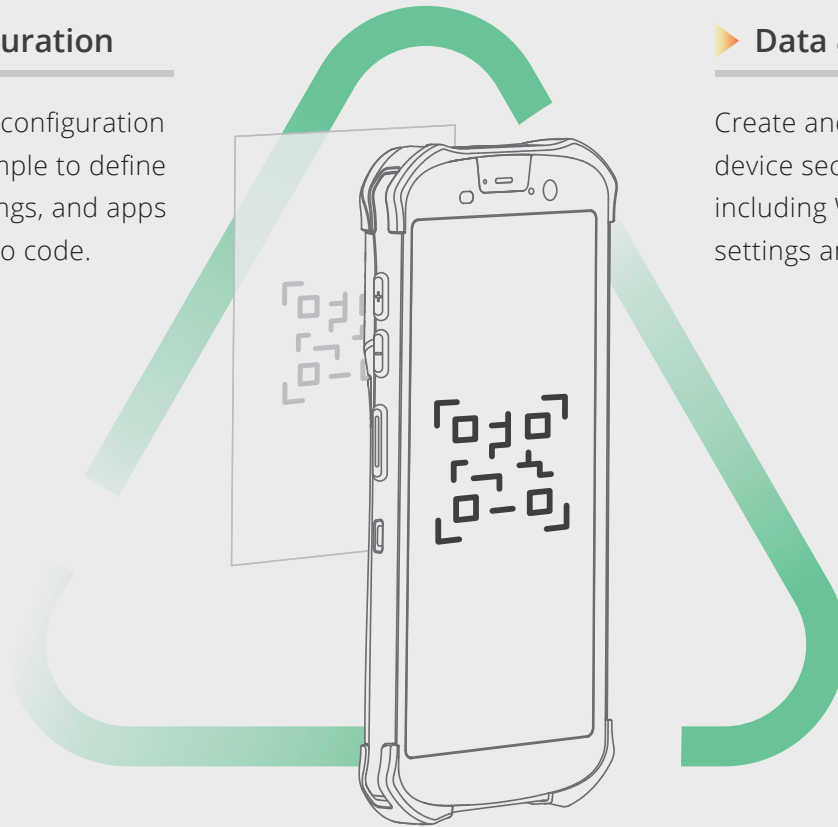

## ▶ Data & Device Security

Create and control data and device security for networks including Wi-Fi, cellular, settings and more

## ▶ Error-Free Configuration

Simply print a configuration QR code and scan to automatically configure devices error-free and without costly manual procedures.

<b>Supported Platforms</b>	Workstation Tool, Windows 7 and newer
<b>Supported Devices</b>	RC40; Android 14 and later
<b>Software Capabilities</b>	Connect your device to network , Configure device settings and security, Perform OS updates, Install and launch applications, Wipe and reset the device, Manage mobile profiles, Managing device Wi-fi, Cellular, Hotspot, Bluetooth



**Askey International Corporation**

4017 Clipper Court, Fremont CA 94538, U.S.A.

[www.askey.com](http://www.askey.com)

[sales@askey.com](mailto:sales@askey.com)

Rev. 4/2025